

S.E. CORNER OF CONCRETE FOOTING FOR GAS PUMP
AT GRAND LAKE RESORT ON SE END OF LAKE.
M.L.S.M.-32'

MINNESOTA 1993
UNIVERSITY OF MINNESOTA
DIVISION OF FISH AND WILDLIFE

Addressed to: Department of Conservation
Department of Conservation
1000 University Avenue, S.E.
St. Paul, Minnesota 55106
612/221-4999 or 612/221-4998
1-800-457-6767

THIS DOCUMENT IS THE PROPERTY OF THE MINNESOTA DEPARTMENT OF CONSERVATION, ST. PAUL, MN. NO RESPONSIBILITY IS ASSUMED FOR THE LOSS OR DESTRUCTION OF THIS DOCUMENT OR FOR THE ACCURACY OF THE DATA SHOWN OR FOR ANY ADJUSTMENTS MADE BY OTHER AGENCIES. PLEASE RETURN TO THE SOURCE FOR CREDIT.

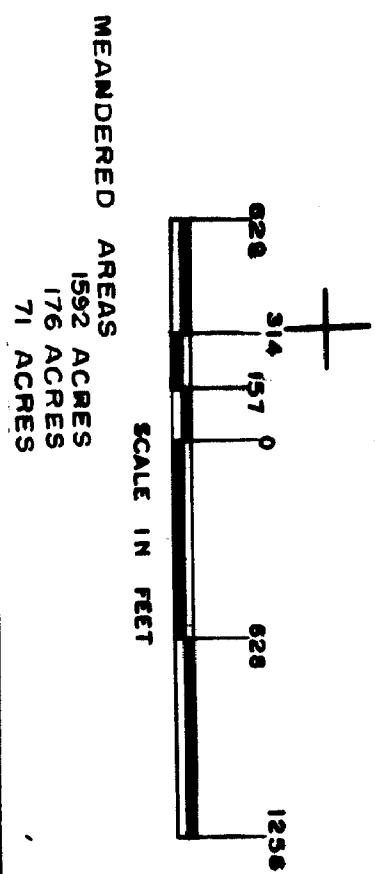

State of Minnesota 1858

DCW
NO. 1
1-399

OUTLINE TRACED FROM 1940 U.S.G.A. PHOTO.

| | | | |
|--|----------|---------------------------|------------|
| STATE OF MINNESOTA | | | |
| DEPARTMENT OF CONSERVATION | | | |
| DIVISION OF GAME AND FISH | | | |
| BUREAU OF FISHERIES FISH RESEARCH UNIT | | | |
| BIG GRAND LAKE | | | |
| ST. LOUIS COUNTY | | | |
| TWP. 31 N. | R. 18 W. | SEC. 18-20-22-28-30-31-32 | |
| FIELDWORK | DRAWN BY | PROJ. SHEET NO. | DATE |
| 10-4-53 | H.K. | 1-10-58 | 8.1.7-11-5 |

17-11

B 259